



WARNING

Proper operation of your brakes is essential for your safety and the safety of others. Any brake service should be performed ONLY by persons experienced in the installation and proper operation of brake systems. It is the responsibility of the person installing any brake component or kit to determine the suitability of the component or kit for the particular application. After installation and before operating your vehicle, be sure to test the function of the brakes under controlled conditions.

DO NOT DRIVE WITH UNTESTED BRAKES!

FOR TECHNICAL ASSISTANCE CALL:

888-533-1199

MONDAY - FRIDAY

8:00 AM TO 5:00 PM EST

IMPORTANT

Take time to read all the literature that came with this kit. Check the provided list of parts against what you received to ensure all parts are present. While this kit was designed to make the process of changing brake parts as simple as possible. **NOTE: WITH SOME KITS IT MAY BE NECESSARY TO MAKE MINOR CHANGES TO YOUR CAR!**

READ ALL WARRANTY DISCLAIMERS AND RETURN POLICIES INCLUDED IN THIS KIT PRIOR TO INSTALLATION!

MASTER POWER BRAKES

110 CROSSLAKE PARK RD. MOORESVILLE, N.C. 28117

www.mpbrakes.com



PA1502KPO

1928-32 FORD POWER BRAKES

UNIVERSAL WELD ON ASSEMBLY

IT'S MORE THAN BRAKES...IT'S CONFIDENCE!

INSTALLATION INSTRUCTIONS

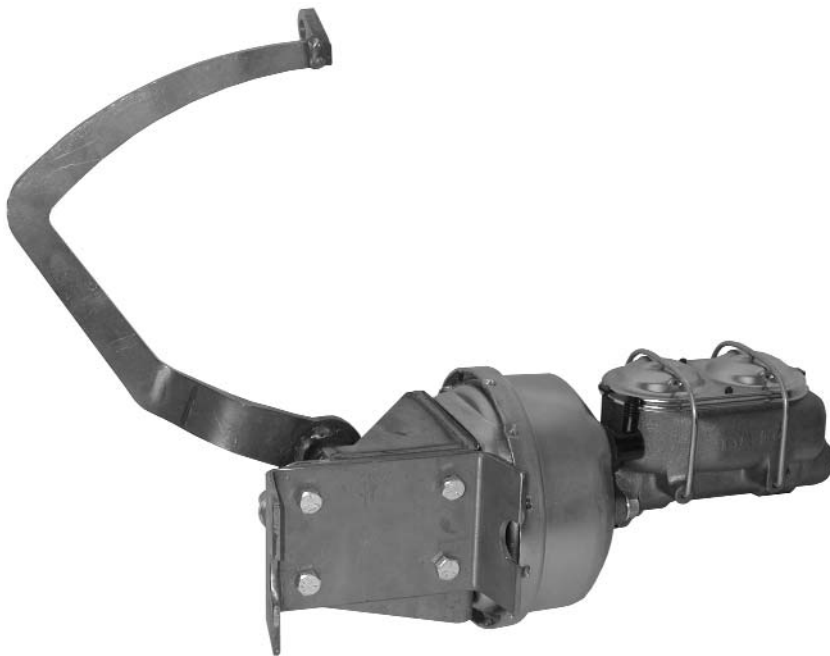

MASTER POWER BRAKES

110 CROSSLAKE PARK RD MOORESVILLE N.C. 28117

www.mpbrakes.com 704-664-8866



REVISED 11/1/05

INSTALLATION INSTRUCTIONS

INCLUDED COMPONENTS

Your power brake conversion kit will contain the following components:

1. Weld on frame channel
2. Thru the floor pedal arm
3. 7" street rod power booster
4. Dual outlet master cylinder

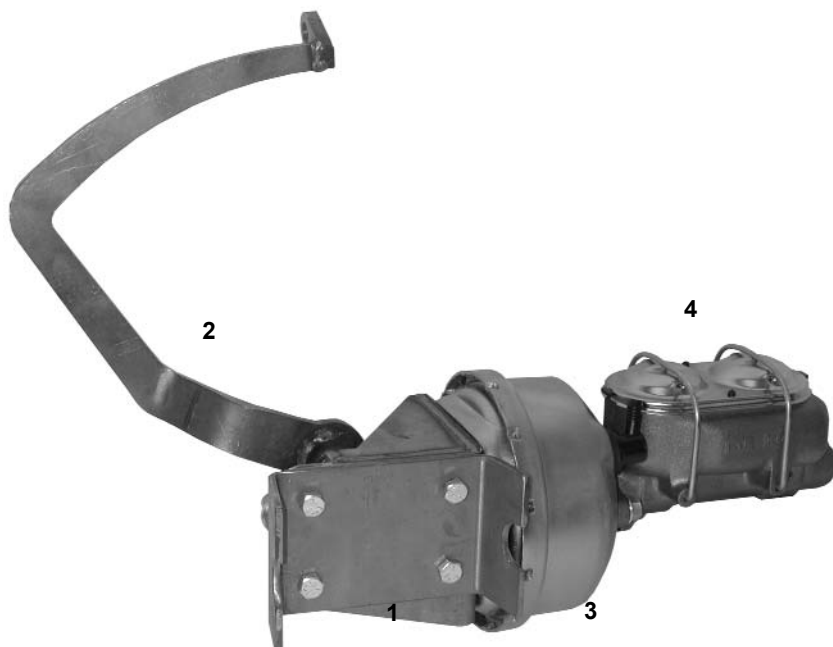

INSTALLATION ON MODEL A

1. For installation on the model A the center of the pedal pivot must be $41 \frac{3}{4}$ " back from the center of the radiator mounting hole (A).

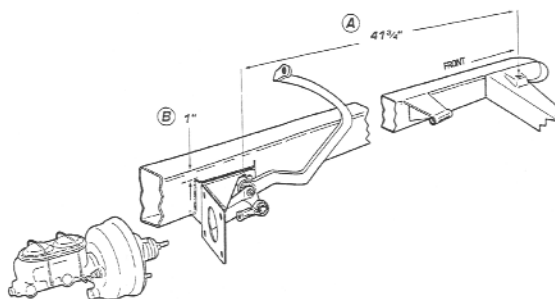

2. The top of the mounting bracket should be located parallel to and 1" below the top of the frame rail (B).
3. This is a weld on pedal assembly and welding should only be performed by a qualified welder.
4. The above dimensions place the pedal assembly in the optimum position for use on the model A chassis. Minor changes may be required for best fit to the chassis.
5. After mounting the pedal bracketry you must first bench bleed the master cylinder to remove all air.
6. Install the power booster onto the bracket and supply with at least 18" vacuum.
7. Mount the master to the booster and attach brake line. The outlet closest to the booster should feed the rear brakes.
8. Bleed the entire brake system and test drive the vehicle before using.

INSTALLATION ON 32 FORD

1. For installation on the model A the center of the pedal pivot must be 42 1/2" back from the center of the radiator mounting hole (A).

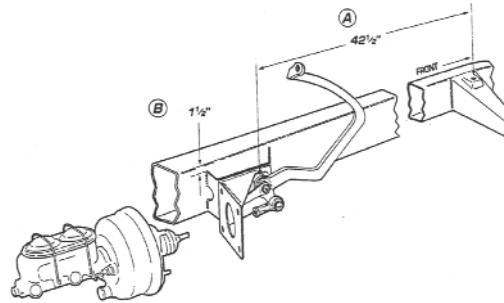

2. The top of the mounting bracket should be located parallel to and 1 1/2" below the top of the frame rail (B).
3. This is a weld on pedal assembly and welding should only be performed by a qualified welder.
4. The above dimensions place the pedal assembly in the optimum position for use on the 32 Ford chassis. Minor changes may be required for best fit to the chassis.
5. After mounting the pedal bracketry you must first bench bleed the master cylinder to remove all air.
6. Install the power booster onto the bracket and supply with at least 18" vacuum.
7. Mount the master to the booster and attach brake line. The outlet closest to the booster should feed the rear brakes.
8. Bleed the entire brake system and test drive the vehicle before using.

WHAT TO DO IF YOU CAN'T GET A BRAKE PEDAL

1. Did you bench bleed the master?
2. Are the front caliper bleeder screws facing up?
3. Is there a 10 lb residual valve to the rear drum brakes?
4. Check the master cylinder by plugging both outlets. If the master is good the pedal will be firm. If the master is bad the pedal will go to the floor.
5. If you have rear calipers the caliper pistons must be adjusted outward so the pads are close to the rotor.

PA1502 UNIVERSAL PEDAL ASSEMBLY PARTS LIST

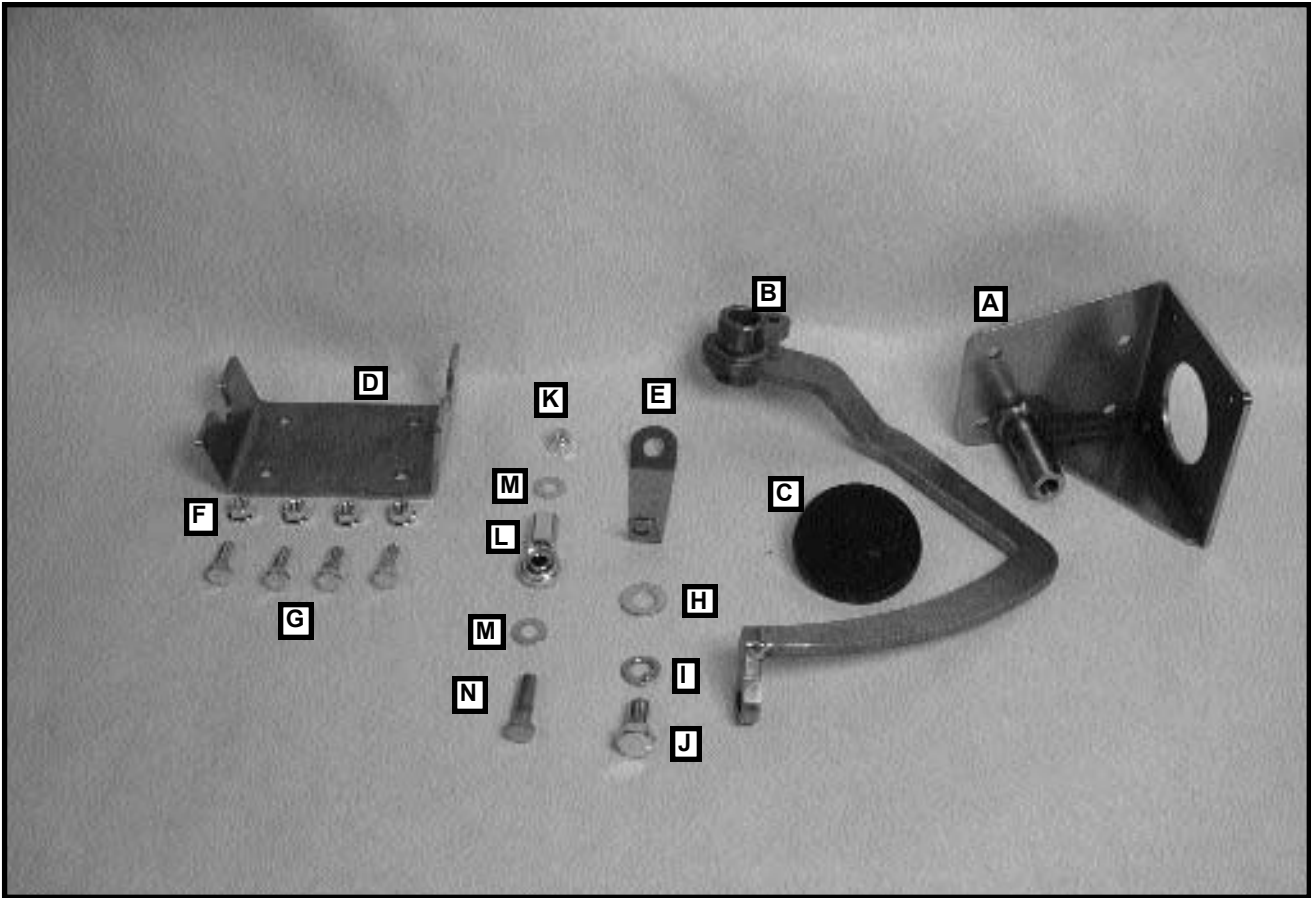

PARTS LIST

- A) PA1502 PEDAL BRACKET
- B) PA1502 PEDAL ARM
- C) HW15093 PEDAL PAD
- D) PA1502 FRAME BRACKET
- E) PA1502 SUPPORT BRACKET
- F) (4) 37CNWFZ NUT 3/8-16 WHIZ FLANGE
- G) (4) 37C100HCS5Z BOLT 3/8-16X1
- H) (1) 50NWSAIY FLAT WASHER 1/2
- I) (1) 50NLOC8Y WASHER, LOCK 1/2 SPLIT
- J) (1) 50F100HCS5Z 1/2-20X1
- K) (1) 37FNNEZ NUT 3/8-24 NYLOCK
- L) (1) HW4034 ROD END, FEMALE 3/8-24
- M) (2) 37NSAEFWZ FLAT WASHER 3/8
- N) (1) 37F175HCS8Y BOLT 3/8-24 X1 3/4

MASTER POWER BRAKES 888-533-1199

Revised 4/1/04