

BM1522

1964-1966 Mustang

Parts List

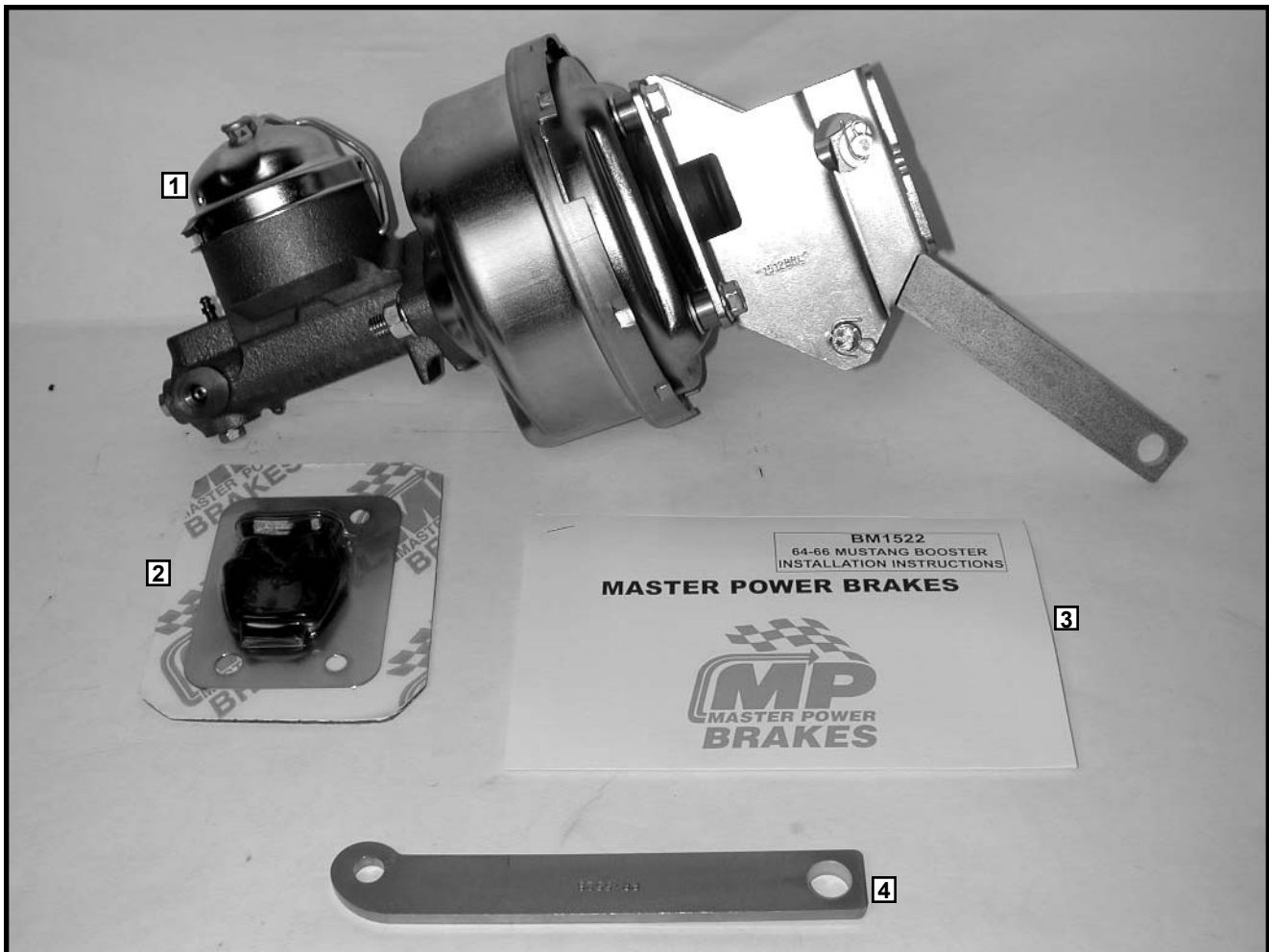

Parts included in the box:

1. (1) Booster and master unit with bracket and push rod assembly.
2. (1) Firewall plate and boot kit.
3. (1) Set of instructions.
4. (1) Longer push rod

Master Power Brakes
888-533-1199

BM1522

Installation Instructions

WARNING:

Installation of any component or kit should only be performed by persons experienced in the installation and proper operation of brake systems. It is also the responsibility of the person installing any brake component or kit to determine the suitability of the component or kit for that particular application.

NOTE:

Before operating the vehicle after installation test the function of the brakes under controlled conditions. Make several stops in a safe area from low speed and gradually work up to normal speeds. **DO NOT DRIVE WITH UNTESTED BRAKES!**
Always utilize safety restraints when operating the vehicle.

STEP 1:

1. Check to be sure that your kit has all the necessary parts needed to complete this project! (Use the supplied parts list as a check list.)

STEP 2:

Remove the following components from your car:

Tech tip: Prior to disassembly spray the nuts and bolts that you will be removing with a penetrant. (Also disconnect the battery to eliminate the risk of draining the battery or an electrical short.)

1. Disconnect the brake lines to the master cylinder.
2. Next, remove the push rod from the brake pedal.
3. Then remove the old manual master.

STEP 3:

Things to prepare before assembly of the new booster & master kit.

1. Remove the new master cylinder from the booster assembly.
2. Bench bleed the new master cylinder to remove all the air. If all the air is removed from the master, then it will be difficult to push the piston in.

How to bench bleed:

Remove the master from the booster and place in a vice. (Be sure to clamp onto the mounting ear and not the cylinder.)

Install the proper size plugs in the outlet ports of the master.

Fill the master cylinder to the full line with brake fluid.

Use a rounded end rod or a phillips head screw driver and push the piston in repeatedly until no bubbles are visible.

NOTE: This may take a minute or two of continuous pumping!

STEP 4:

Installation of booster & master components:

1. Install the new booster with bracket to the firewall using the four studs or holes where the original master was located and secure. **(Be sure to place the firewall boot and plate between the booster brackets and the firewall.)**

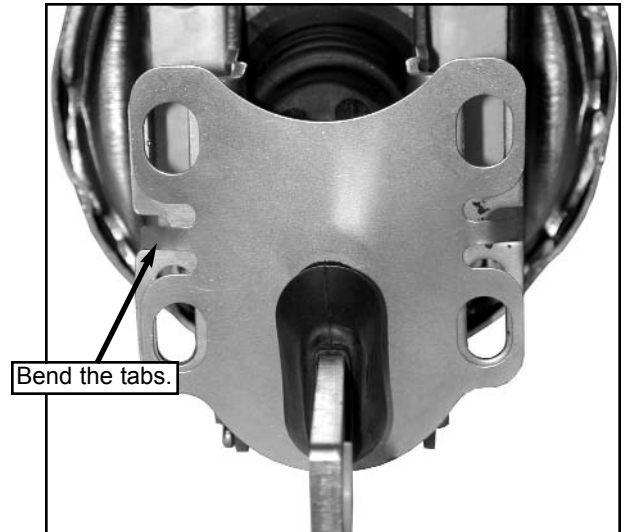
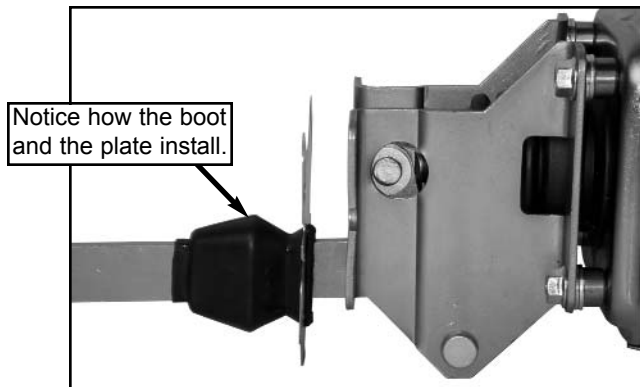

2. Now attach the booster push rod to the original location on the brake pedal. **(The push rod should attach with no pressure on the pedal.)**
3. Mount the master cylinder to the booster. **(Make sure that the master was properly bled.)**

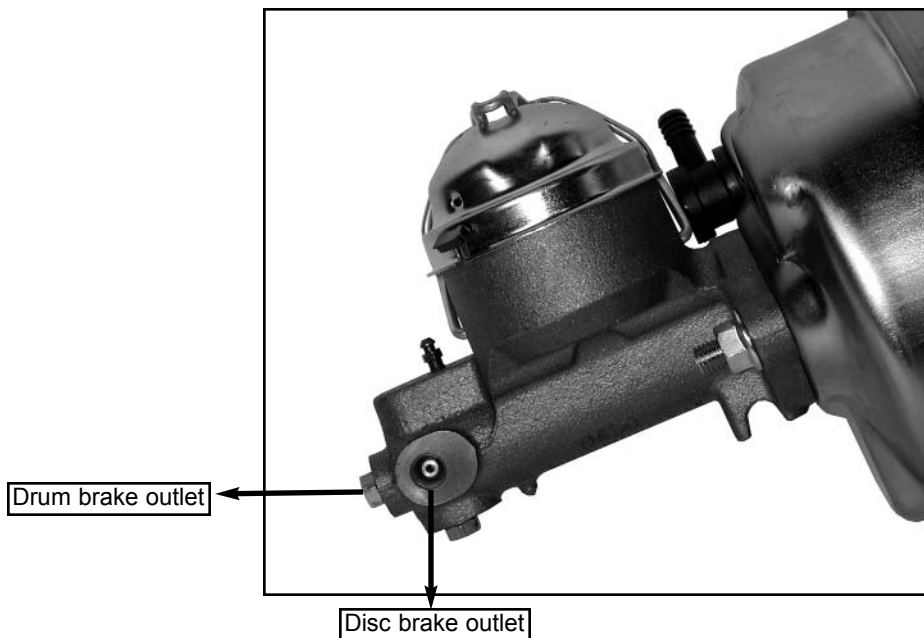

5. Connect the vacuum fitting and the hose to either the intake manifold or to the rear of the carburetor. Make sure that the vacuum source on the carburetor is manifold vacuum and not timed vacuum. **Note: The engine must provide a minimum of 18" of vacuum for the booster to work effectively.**

6. Attach the brake line to the master. If your kit came with an adjustable valve, go ahead and install it. **(Be sure to keep all lines away from exhaust, steering or other things that could harm them.)** When installing an adjustable valve connect the line from the master into the valve and then into the stock system. If you are not using a valve just connect the stock system into the master at the specified outlet. Bleed the entire system.

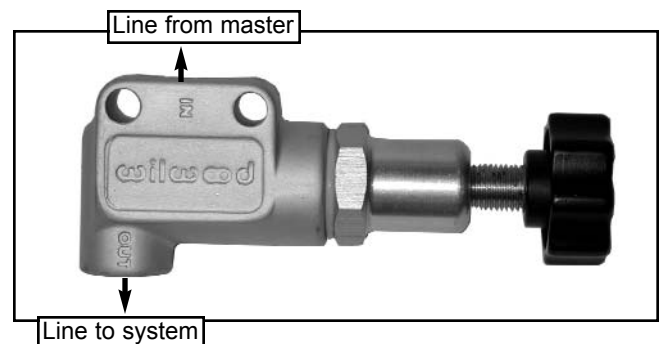

7. Reconnect the battery and start the engine. Test the brakes. If the pedal goes to the floor or is very spongy then bleed the system once again.
8. Test drive the car in a safe location before driving.



Master Power Brakes
888-533-1199