



# MASTER POWER BRAKES

110 Crosslake Park Road, Mooresville, NC 28117

Website: [www.mpbrakes.com](http://www.mpbrakes.com)

Technical Support: 888-533-1199

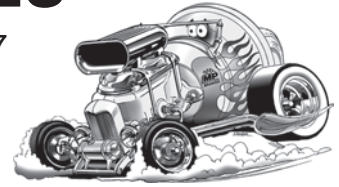

## WARNING

Proper operation of your brakes is essential for your safety and the safety of others. Any brake service should be performed **ONLY** by persons experienced in the installation and proper operation of brake systems. It is the responsibility of the person installing the component or kit for the particular application. After installation and before operating your vehicle, be sure to test the function of the brakes under controlled conditions.

→ **DO NOT DRIVE WITH UNTESTED BRAKES!** ←

FOR TECHNICAL ASSISTANCE CALL:

**888-533-1199**

MONDAY - FRIDAY

8:00 A.M. TO 5:00 P.M. E.S.T.

## CHECK ORDER IMMEDIATELY WARRANTY INFORMATION

Take time to read all the literature that came with this kit. Check the provided list of parts against what you received to ensure all parts are present. While this kit was designed to make the process of changing brake parts as simple as possible, **with some kits it may be necessary to make minor changes to your car.**

***Read all warranty disclaimers and return policies included in this kit prior to installation.***

You have: **5 days** to declare shipping damages  
**30 days** to declare missing or incorrect parts  
**90 days** for exchanges or returns (RA req'd)  
**1 year** before product warranty expires.

*No exceptions allowed.*

*Thank you for your business!*



MASTER POWER BRAKES

110 Crosslake Park Road, Mooresville, NC 28117

Website: [www.mpbrakes.com](http://www.mpbrakes.com) Technical Support: 888-533-1199

© 2006 MP Brakes. All rights reserved. Master Power® is a registered trademark of Master Power Brakes, LLC



# DR1504K INSTALLATION INSTRUCTIONS

The DR1501K pre assembled drum brake kit is designed to directly replace the smaller rear drums on a Ford 9" large bearing. This rear drum kit will not require any special master cylinder or valves to function properly. The emergency brake cable on the car will hook up directly to the new kit.

**NOTE: Clean the drum with brake cleaner followed by soap and water before assembly**



1. Chock the front wheels so the car can not roll and Jack up the rear of the car.
2. Remove the rear wheel.
3. Remove the drum.
4. Disconnect the parking brake cable. Use a small hose clamp around the cable lock prongs and pull the cable through the backing plate.
5. Remove the rear axle.
6. Remove the old drum brake backing plate with all components attached.
7. Bolt on the new pre assembled backing plate. The backing plates are marked left and right. Be sure to put on correct side.
8. Re install the rear axle.
9. Re connect the parking brake cable.
10. Check the centerbore of the drum on the axle pilot. If the drum centerbore is larger than the pilot, install the two center rings, one on each axle pilot.
11. Clean the new drum as described above.
12. Mount the new drum.
13. Repeat on other side and adjust the drum brakes as necessary.
14. Bleed the entire system and test drive before using.

**DR1504K  
DRUM BRAKE KIT  
PARTS LIST**



**MASTER POWER BRAKES 888-533-1199**

Revised 10/6/03

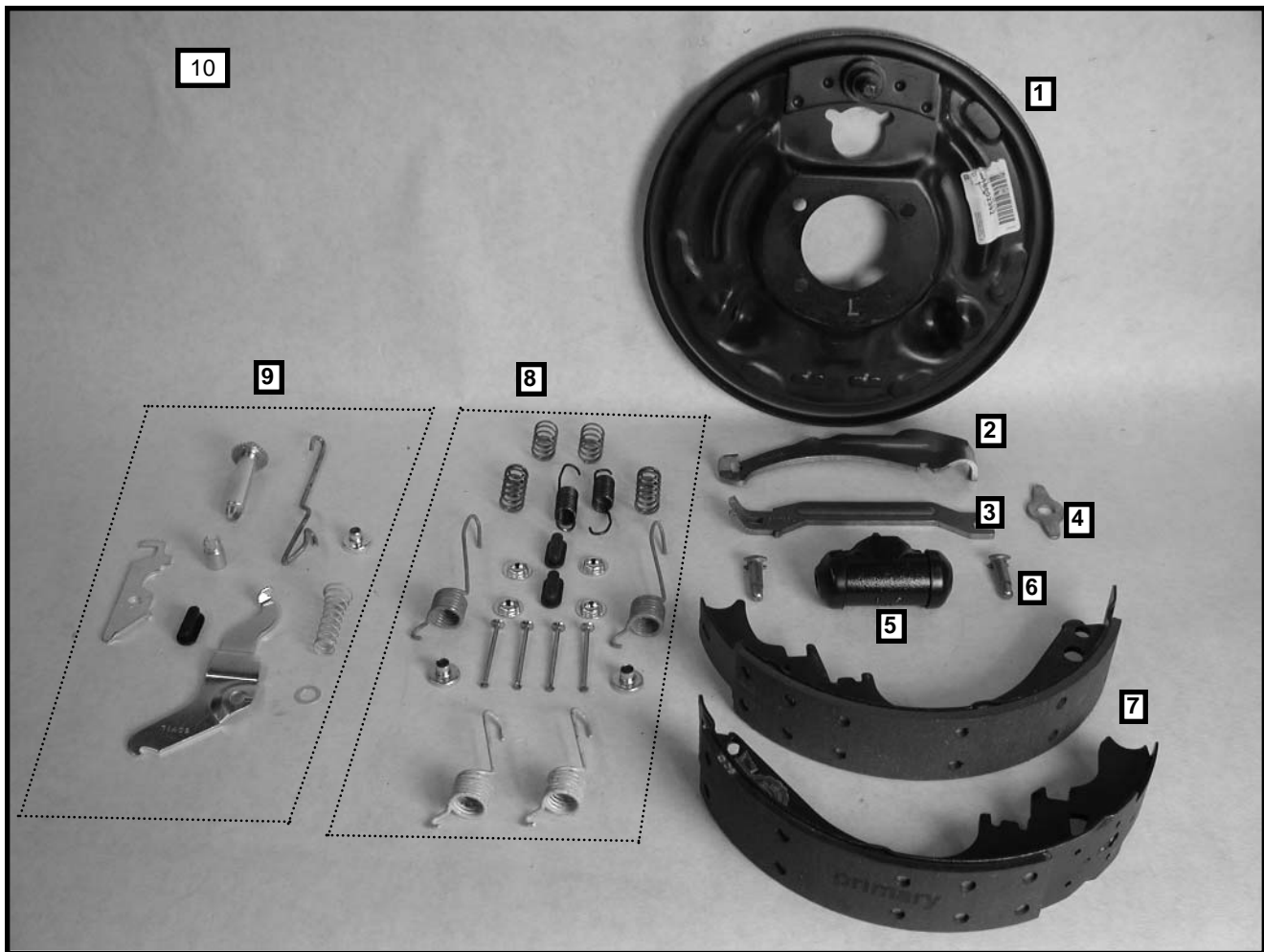

**PARTS LIST**

- |                                      |                                |
|--------------------------------------|--------------------------------|
| 1) (2) BA1504 (RIGHT AND LEFT)       | 10) (2) HW3332 CENTERING RINGS |
| 2) (2) LV1795L E-BRAKE LEVER (LEFT)  |                                |
| (2) LV1795R E-BRAKE LEVER (RIGHT)    |                                |
| 3) (2) SR1795L E-BRAKE LEVER (LEFT)  |                                |
| (2) SR1795R E-BRAKE LEVER (RIGHT)    |                                |
| 4) (2) HW1795 ANCHOR WASHER          |                                |
| 5) (2) HW78-37080 WHEEL CYLINDER     |                                |
| 6) (4) HW1422 WHEEL CYLINDER PIN     |                                |
| 7) (1) HWPS-462 11 X 2 STAGE 1 SHOES |                                |
| (4) BRAKE SHOES                      |                                |
| 8) (1) HW7150K AXLE SPRING KIT       |                                |
| 9) (1) HW2550 ADJUSTER KIT (LEFT)    |                                |
| (1) HW2551 ADJUSTER KIT (RIGHT)      |                                |